

ISO Light **TECH** Box™



The ISO Light **TECH** Box™ is a durable and reusable packaging container which combines the advantages of the Light **TECH** Box™ with the isolating properties of EPP. The thermal isolation guarantees a high temperature resistance from +/-4 °C up to 45 hours.

Economical and Ecological

- thermal isolating large container made of polypropylene
- minimum 50% lighter than comparable containers
- 30% more volume than typical cooling tanks
- more than 50% volume reduction in return
- saves costs of stocking and transportation
- no additional packaging material necessary
- 100% recyclable



collapsed EPP-lining

Robust

- thermal isolating EPP-lining (expandable polypropylene)
- dimensionally stable
- stackable
- locking systems
- weather-resistant

Flexible

- thermal isolating EPP-lining as a folding system
- space saving-collapsed in seconds
- accessible from all four sides
- high rack able and block storage able
- individual imprint, customer logo, etc.



ISO Light TECH Box™

The ISO Light **TECH** Box™ was developed for a safe transportation and storage of products in pharmaceutical and chemical industries as well as primary packaging of food and non-food goods. It is available in two versions:

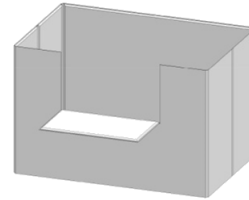

single piece sleeve
with two load
doors

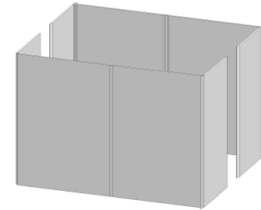

multi-part symmetric
sleeve plus a small sleeve
for a volume reduction in
return



dimension of full container	1212 x 810 x 1155 mm
dimension in return	1212 x 810 x 610 mm
internal dimension	1050 x 650 x 850 mm
payload	750 kg
filling- loading volume	580 L per box
handling size of single sleeve	770 mm
handling size of multi-part sleeve	580 mm
tare weight	50 kg
heat transition coefficient	0,042 W/(m*K)
isolating behaviour (without coolant)	+/-4°C up to 45 hours
max. stackable load dynamic	750 kg
max. stackable load static	1500 kg